

## ■ Replacement Parts List

**Notes:** \*Important safety notice:

 Components identified by  $\Delta$  mark have special characteristics important for safety.

Furthermore, special parts which have purposes of fire-retardant (resistors), high-quality sound (capacitors), low-noise (resistors), etc. are used.

When replacing any of components, be sure to use only manufacturer's specified parts shown in the parts list.

\*The parenthesized indications in the Remarks columns specify the areas. (Refer to the cover page for area.)

Parts without these indications can be used for all areas.

Ref. No.	Part No.	Part Name & Description	Remarks	Ref. No.	Part No.	Part Name & Description	Remarks
		INTEGRATED CIRCUIT(S)				VARIABLE RESISTOR(S)	
IC101	AN6558F	IC, PHONO EQ AMP.		VR201	EUWMGEF20B15	V. R, MAIN VOLUME	
IC201	TC9163N	IC, INPUT SELECTOR		VR202	EVJ02QF02G15	V. R, BALANCE	
IC202	TC9164N	IC, INPUT SELECTOR		VR301	EVJYA1F02C15	V. R, TONE CONTROL	
IC251	BA6218	IC, MOTOR DRIVE		VR302	EVJYA1F02C15	V. R, TONE CONTROL	
IC301	NJM4580DD	IC, TONE AMP.				COMPONENT COMBINATION(S)	
IC601	M5F78M05L	IC, REGULATOR	$\Delta$				
IC701	M37470M2332S	IC, MICRO COMPUTER		Z801	RCDGP1U28XD	REMOTE SENSOR	
IC801	TC74HC42AP	IC, LED DRIVE				COIL(S)	
		TRANSISTOR(S)					
Q201	DTC114YSTP	TRANSISTOR		L251, 252	ELEXT1R0KA9	COIL	
Q202	DTA124ESTP	TRANSISTOR		L301-308	ELEXT100KA9	COIL	
Q351, 352	2SC3327-A	TRANSISTOR		L309	BL02RN1R62T2	COIL	
Q601, 602	DTA124ESTP	TRANSISTOR		L601-605	ELEXT1R0KA9	COIL	
Q603	DTC144ESTP	TRANSISTOR		L606, 607	ELEXT1R0KA9	COIL	$\Delta$
Q622	DTC114YSTP	TRANSISTOR		L701	ELEXT101KA9	COIL	
Q623	DTA124ESTP	TRANSISTOR				OSCILLATOR(S)	
Q701	DTC114ESTP	TRANSISTOR					
Q702	DTC114TSTP	TRANSISTOR		X701	EF0GC4004A4	OSCILLATOR (4MHz)	
Q703, 704	DTC114YSTP	TRANSISTOR				SWITCH(ES)	
Q709	2SA933QRSTA	TRANSISTOR					
Q710	DTC114ESTP	TRANSISTOR		S301	ESB68047	SW, TONE (DEFEAT/ON)	
		DIODE(S)		S801	EVQ21405R	SW, POWER (STANDBY/ON)	
D201	MA165	DIODE		S802	EVQ21405R	SW, TAPE MONITOR	
D601	MA165	DIODE		S804	RSR9A001-A	SW, SELECTOR	
D621	MA165	DIODE				CONNECTOR(S)	
D651-654	RL1N4003N02	DIODE	$\Delta$				
D655, 656	MA167	DIODE	$\Delta$	CN201, 202	RJS1A6603	CONNECTOR(3P)	
D658	MA4056MTA	DIODE	$\Delta$	CN203	SJT3611	CONNECTOR(6P)	
D701	1SS291TA	DIODE		CN301A	RJS1A6603	CONNECTOR(3P)	
D703	MA29WA	DIODE		CN301B	RJS1A6604	CONNECTOR(4P)	
D704	1SS291TA	DIODE		CN701	RJS1A6604	CONNECTOR(4P)	
D705, 706	MA165	DIODE		CN702A	RJS1A6605	CONNECTOR(5P)	
D708-710	MA165	DIODE		CN702B	RJS1A6604	CONNECTOR(4P)	
D711	SLR-305VC	L. E. D.		TP1-5	QJT1090	TEST POINT	
D712	MA165	DIODE				EARTH TERMINAL	
D801-807	SLR-305VC	L. E. D.					
D810	SLR-305VC	L. E. D.		E201, 202	SNE1004-2	GND PLATE	
D811, 812	SLR-305DC	L. E. D.					
D813	SLR-305VC	L. E. D.					



# Cabinet Parts Location

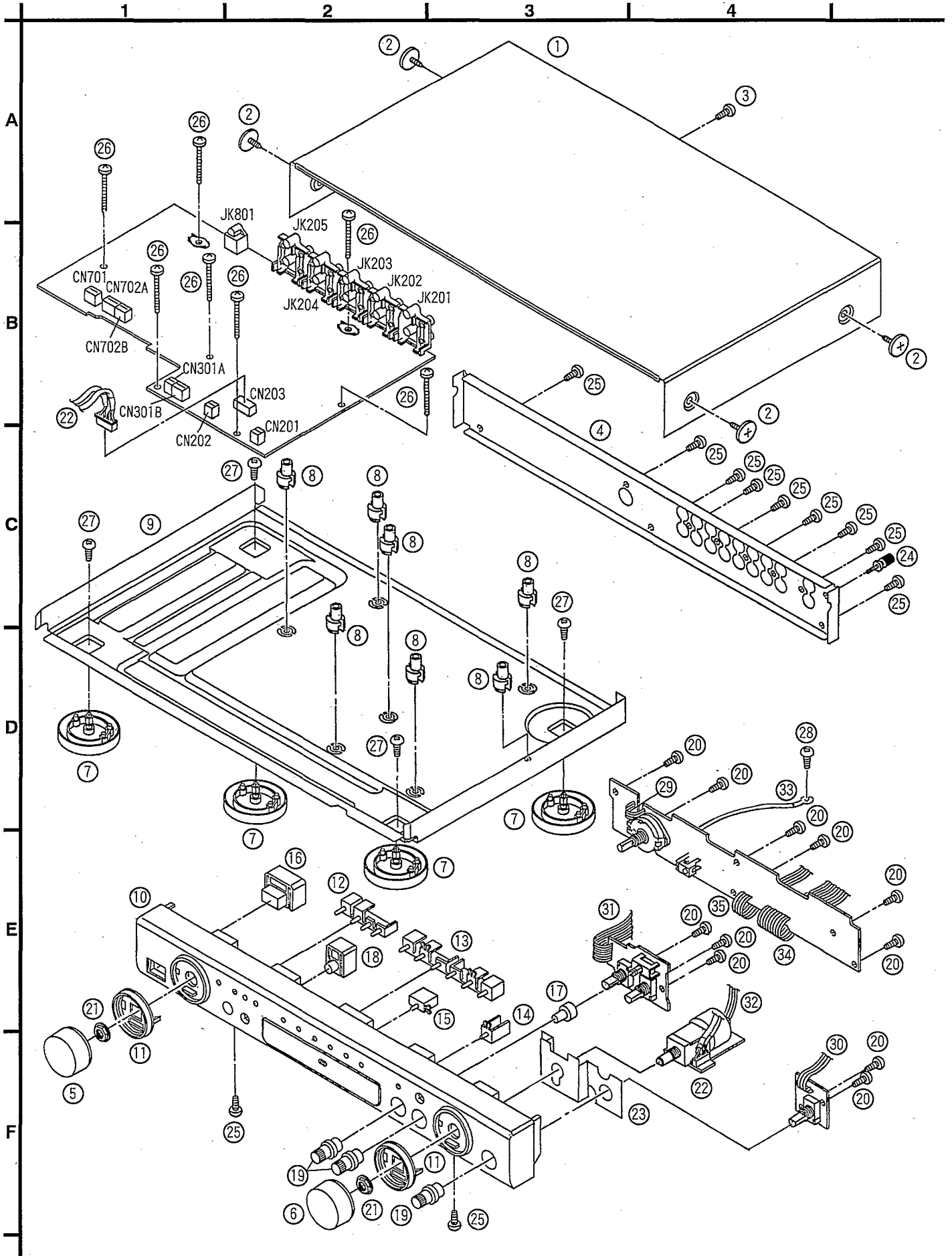

Notes : \* Capacity values are in microfarads ( $\mu\text{F}$ ) unless specified otherwise, P=Pico-farads ( $\text{pF}$ ) F=Farads (F)  
 \* Resistance values are in ohms, unless specified otherwise, 1K=1,000(OHM) , 1M=1,000k(OHM)

Ref. No.	Part No.	Values & Remarks	Ref. No.	Part No.	Values & Remarks	Ref. No.	Part No.	Values & Remarks
		RESISTORS	R723-725	ERDS2TJ103	1/4W 10K	C305, 306	ECCR1H820JC5	50V 82P
			R726	ERDS2TJ102	1/4W 1K	C309, 310	ECA1HPXS010B	50V 1U
			R801	ERDS2TJ821	1/4W 820	C311, 312	ECCR1H390JC5	50V 39P
R101, 102	ERDS2TJ102	1/4W 1K	R802	ERDS2TJ102	1/4W 1K	C313, 314	ECA1EPX470TB	25V 47U
R103, 104	ERDS2TJ224T	1/4W 220K	R803	ERDS2TJ122	1/4W 1.2K	C315, 316	ECBTOJ153MS5	6.3V 0.015U
R105, 106	ERDS2TJ563	1/4W 56K	R804	ERDS2TJ152	1/4W 1.5K	C317, 318	ECQV1H823JM3	50V 0.082U
R117, 118	ERDS2TJ221	1/4W 220	R805	ERDS2TJ182	1/4W 1.8K	C319, 320	ECBT1C222KR5	16V 2200P
R123, 124	ERDS2TJ680T	1/4W 68	R806	ERDS2TJ222	1/4W 2.2K	C321, 322	ECBTOJ153MS5	6.3V 0.015U
R125, 126	ERDS2TJ123	1/4W 12K	R807	ERDS2TJ332	1/4W 3.3K	C323, 324	ECBT1H121KB5	50V 120P
R127, 128	ERDS2TJ184T	1/4W 180K	R808	ERDS2TJ472	1/4W 4.7K	C325	ECBT1H102KB5	50V 1000P
R129, 130	ERDS2TJ563	1/4W 56K	R809	ERDS2TJ682T	1/4W 6.8K	C327, 328	ECKT1H101KB	50V 100P
R131, 132	ERDS2TJ102	1/4W 1K	R810	ERDS2TJ123	1/4W 12K	C341, 342	ECBT1C332KR5	16V 3300P
R201-210	ERDAS3G102T	1/4W 1K	R811	ERDS2TJ223	1/4W 22K	C351, 352	ECKR1H103ZF5	50V 0.01U
R211, 212	ERDS2TJ102	1/4W 1K	R812	ERDS2TJ181T	1/4W 180	C601	ECEA1HKA010B	50V 1U
R213, 214	ERDAS3G102T	1/4W 1K	R813, 814	ERDS2TJ151	1/4W 150	C607, 608	ECA1EPXS470B	25V 47U
R215-217	ERDS2TJ103	1/4W 10K	R815	ERDS2TJ271	1/4W 270	C651	ECA1EM222E	25V 2200U
R219-221	ERDS2TJ103	1/4W 10K	R819	ERDS2TJ271	1/4W 270	C655	RCE1CKA470BG	16V 47U
R222, 223	ERDS2TJ102	1/4W 1K	R820	ERDS2TJ223	1/4W 22K	C656	ECQV1H104JM3	50V 0.1U
R224	ERDS2TJ472	1/4W 4.7K	R821	ERDS2TJ104	1/4W 100K	C657, 658	ECKR1H103ZF5	50V 0.01U
R225, 226	ERDAS3G222T	1/4W 2.2K	R822	ERDS2TJ271	1/4W 270	C701	ECA0JM102B	6.3V 1000U
R227, 228	ERDS2TJ104	1/4W 100K	R823-825	ERDS2TJ104	1/4W 100K	C702	ECBT1C103NS5	16V 0.01U
R251 $\Delta$	ERDS1FVJ2R2T	1/2W 2.2				C703	RCE1HKAR47BG	50V 0.47U
R301, 302	ERDAS3G101T	1/4W 100			CAPACITORS	C704	ECEA1HKA2R2B	50V 2.2U
R303, 304	ERDS2TJ474	1/4W 470K				C705	ECBT1C103NS5	16V 0.01U
R305, 306	ERDAS3G104	1/4W 100K	C101, 102	ECBT1H181KB5	50V 180P	C706	ECQV1H224JM3	50V 0.22U
R315, 316	ERDS2TJ224T	1/4W 220K	C103, 104	ECA1HPXS4R7B	50V 4.7U	C707, 708	ECEA1HKA2R2B	50V 0.22U
R317, 318	ERDAS3G223T	1/4W 22K	C107, 108	RCE1AKA330BG	10V 33U	C709	ECBT1H102KB5	50V 1000P
R319, 320	ERDAS3G392T	1/4W 3.9K	C113, 114	ECQB1H682JF3	50V 6800P	C801	RCE0JKA101BV	6.3V 100U
R321, 322	ERDS2TJ223	1/4W 22K	C115, 116	ECQB1H223JF3	50V 0.022U			
R323, 324	ERDS2TJ392T	1/4W 3.9K	C117, 118	ECEA1VKA4R7B	35V 4.7U			
R325, 326	ERDS2TJ183T	1/4W 18K	C119, 120	ECQB1H472JF3	50V 4700P			
R327, 328	ERDS2TJ392T	1/4W 3.9K	C121, 122	ECKR1H103ZF5	50V 0.01U			
R329, 330	ERDS2TJ102	1/4W 1K	C123, 124	ECBT1H102KB5	50V 1000P			
R331, 332	ERDAS3G101T	1/4W 100	C201, 202	ECBT1H101KB5	50V 100P			
R333, 334	ERDAS3G221T	1/4W 220	C203, 204	ECKT1H101KB	50V 100P			
R353, 354	ERDS2TJ102	1/4W 1K	C205-208	ECBT1H101KB5	50V 100P			
R655	ERDS2TJ103	1/4W 10K	C209, 210	ECKT1H101KB	50V 100P			
R656 $\Delta$	ERDS1FVJ100T	1/2W 10	C211, 212	ECBT1H101KB5	50V 100P			
R701	ERDS2TJ102	1/4W 1K	C213, 214	ECKT1H101KB	50V 100P			
R702, 703	ERDS2TJ103	1/4W 10K	C215	ECBT1H101KB5	50V 100P			
R704	ERDS2TJ104	1/4W 100K	C217, 218	ECBT1E103ZF	25V 0.01U			
R706	ERDS2TJ103	1/4W 10K	C219, 220	RCE1HKA4R7BG	50V 4.7U			
R707-709	ERDS2TJ104	1/4W 100K	C221	ECBT1H101KB5	50V 100P			
R710-712	ERDS2TJ103	1/4W 10K	C223, 224	RCE1HKA4R7BG	50V 4.7U			
R713	ERDS2TJ102	1/4W 1K	C225, 226	ECBT1E103ZF	25V 0.01U			
R714	ERDS2TJ331	1/4W 330	C251, 252	RCE0JKA101BV	6.3V 100U			
R715, 716	ERDS2TJ273	1/4W 27K	C253, 254	ECQV1H104JM3	50V 0.1U			
R717	ERDS2TJ334	1/4W 330K	C301, 302	ECA1HPXS4R7B	50V 4.7U			
R718-721	ERDS2TJ473	1/4W 47K	C303, 304	ECCR1H470JC5	50V 47P			

992